

Copyright of this document belongs to Archaus Architects Limited.
 All dimensions are in millimetres unless otherwise noted.
 Check and verify all dimensions and levels on site prior to work commencing.
 All work to comply with NZBC, NZS-3604 and Local Territorial Authority regulations.
 Drawings to be read in conjunction with all other relevant documentation.
 Do not scale off drawings.

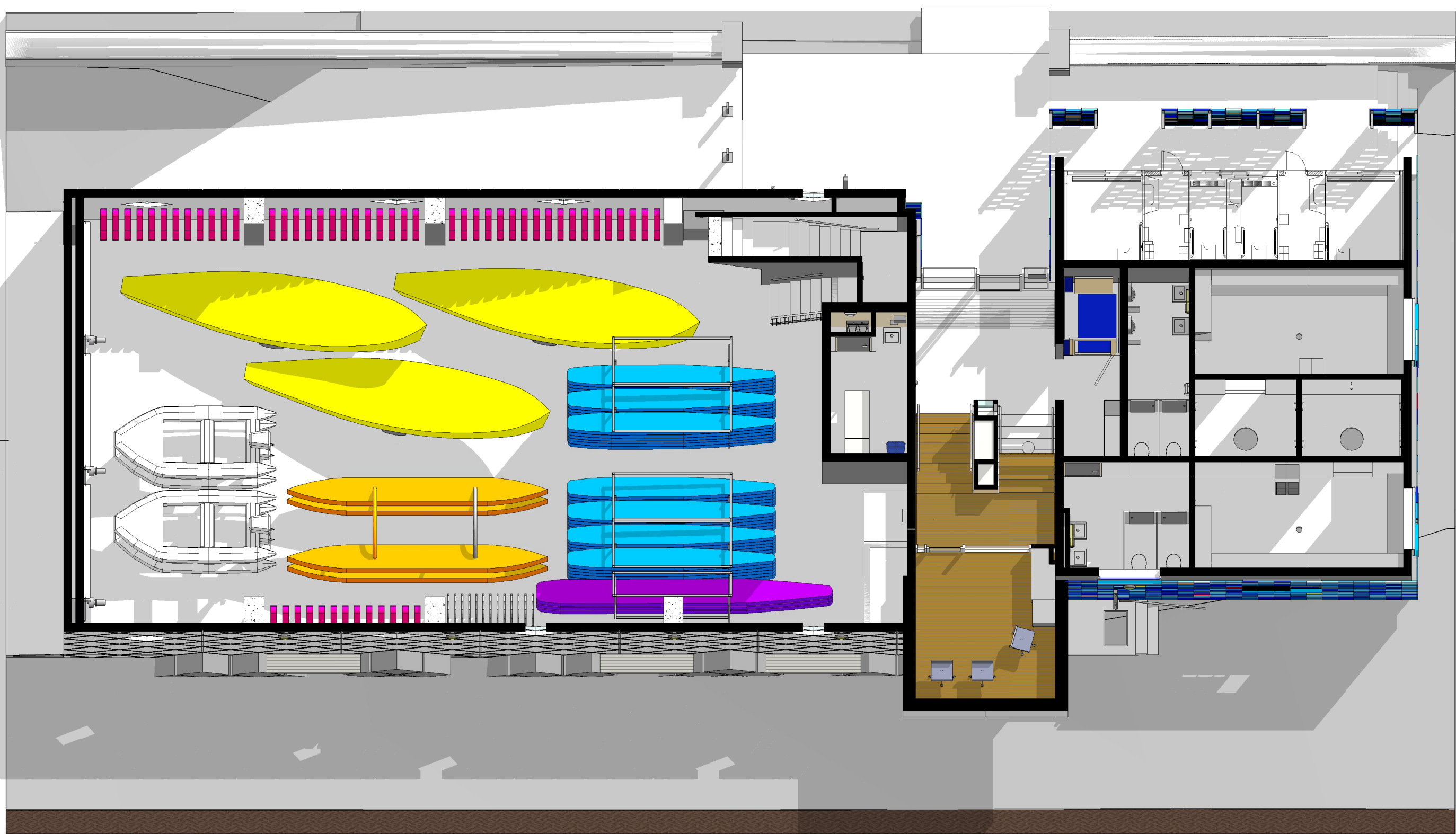

LYALL BAY
 SURF & LIFE SAVING CLUB



REV	DATE	INITIAL	AMENDMENT	ISSUED TO CLIENT
-	07/02/2013	FK		

Detailed Design

CLIENT: Lyall Bay Surf & Life Saving Club
 PROJECT: Proposed New Clubhouse
 Lyall Parade, Lyall Bay, Wellington 6022

STORAGE AND GROUND FLOOR PLAN - 3D

SCALE: at A1, half scale at A3
 DATE: 11/11/2007
 PROJECT No: 07072
 DESIGN: CB
 DRAWN: FK
 SHEET No: 00.23
 REVISION: -

(04) 802 5630 (09) 376 2579
 www.archaus.co.nz

